



LED FIXTURE SPECIFICATION

MODEL # **RFDL**



FINAL MODEL #			
PROJECT			
TYPE		AREA	
NOTES			

STANDARD FEATURES: CEILING INDOOR

Fixture thermally tested to ensure longevity
 Maximum light distribution throughout lens
 Over current/voltage short circuit protection
 UL and/or CSA Compliant Listed
 Constant Current Design

FIXTURE	LED ENGINE
BASE CR Steel Construction	LG/NICHIA/SAMSUNG, LED CHIPS
FINISH Satin Nickel/Ivory Fabric Shade	LUMENS PER WATT AVG 100-120 @Module Efficacy
LENS Frosted Acrylic	KELVIN 27K 30K 35K 40K 50K CRI 80+
LOCATION Damp	DRIVER 120 VOLTS 50/60Hz
COMPLIANT	POWER FACTOR High
LIFE HOURS 50,000	TRIAC OR ELECTRONIC
WARRANTY Limited 5 Years	Low Voltage Dimming Down To 5% With Wall Box Dimmers
MADE IN AMERICA	TESTED LM80 and LM82

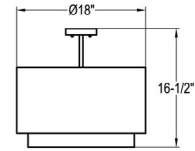

SIZE OPTIONS
D18 H16 ^{1/2}

LED LIGHT SOURCE OPTIONS ORDERING INFORMATION:

WATTAGE: 12	KELVIN: 3000k	SIZE: 5x2
WATTAGE:	KELVIN:	SIZE:

SYSTEM WATTAGE	2700K WARM WHITE	3000K SOFT WHITE	3500K NEUTRAL	4000K COOL WHITE	5000K DAYLIGHT	LEGACY EQUIVALENT
10/12 DRIVERLESS		1000/1000		1000/1050		CFL 13
14/15 DRIVERLESS		1350/1500		1400/1500		CFL 2 x 13
22/24 DRIVERLESS		1850/2400		1900/2500		CFL 3 x 13
10	1060	1100	1160	1175	1250	CFL 18
12	1265	1360	1405	1460	1560	CFL 2 x 13
16	1650	1700	1720	1750	1800	CFL 2 x 18
20	2100	2140	2180	2200	2250	CFL 2 x 26
24	2570	2740	2830	2950	3150	CFL 2 x 32
31	3000	3165	3250	3400	3640	CFL 4 x 26
38	3695	3950	4075	4250	4540	CFL 4 x 42

SPECIAL OPTIONS (please specify if applicable)

DRIVER: DVD	FINISH: FCU	LENS: LCU	ACCESSORIES: FUS	TECHNOLOGY: CT
-------------	-------------	-----------	------------------	----------------

DRIVER:	FINISH:	LENS:	ACCESSORIES:	TECHNOLOGY:
---------	---------	-------	--------------	-------------

DRIVER	FINISH	LENS	ACCESSORIES	TECHNOLOGY
<input type="checkbox"/> DV 120/277 (Non Dimmable) <input type="checkbox"/> DVD 120/277 (0-10v Dimmable)	<input type="checkbox"/> FB Black <input type="checkbox"/> FBR Bronzestone <input type="checkbox"/> FCU Custom Any RAL Finish <input type="checkbox"/> FSN Satin Nickel <input type="checkbox"/> FW White	<input type="checkbox"/> LCU Custom	<input type="checkbox"/> CCS Cable, Cord Suspension System <input type="checkbox"/> CPS Cable, Pendant Suspension System <input type="checkbox"/> FI Finial <input type="checkbox"/> FUS Fused <input type="checkbox"/> IB Individually Boxed <input type="checkbox"/> PCH Pull Chain <input type="checkbox"/> PK1 Canopy/Pendant Kit/1 ROD <input type="checkbox"/> PK2 Canopy/Pendant Kit/2 RODS <input type="checkbox"/> PK3 Canopy/Pendant Kit/3 RODS <input type="checkbox"/> SRP Surge Protection	<input type="checkbox"/> BLD Bi-Level Dimming <input type="checkbox"/> CT LED Color Tuning <input type="checkbox"/> EMG Emergency (Any Lumens Package) <input type="checkbox"/> EMGR Emergency Remote <input type="checkbox"/> OS Occupancy Sensor On/Off <input type="checkbox"/> OSCD Occupancy Sensor Step Dimming

