



# Fixture Specification

MODEL #: **OFT**

STYLE / LAMP / LAMP / WATTAGE / KELVIN / BALLAST / FINISH / LENS / ACCESSORIES / SIZE / COMPLIANCE  
 QTY TYPE DETAIL

PROJECT : \_\_\_\_\_ TYPE : \_\_\_\_\_ NOTE : \_\_\_\_\_

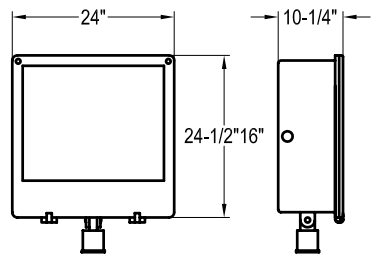
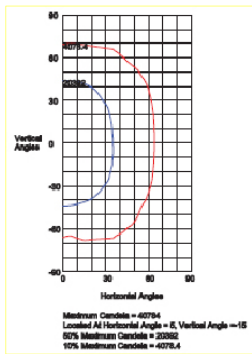

**Light Source**

Type	High Pressure Sodium		Metal Halide		LED		Induction			
Wattage	400	1000	400	1000	7.5	15	120	150	200	300
Quantity	1	1	1	1	-	8/10	1	1	1	1

**Standard Features**

<b>BASE</b>	Die Cast Aluminum Hinged Top Frame Safety Cable Restraint 1/2" Coin Plugs with O-rings for Conduit and/or Photo Cell	<b>FINISH</b>	Bronzetone	<b>LENS</b>	Tempered Flat Clear Glass
<b>LISTING &amp; RATING</b>	UL Listed Wet Location	<b>LAMP</b>	LED - 2700K Induction - 5000K	<b>REFLECTOR</b>	Aluminum Smooth
		<b>ELECTRICAL/INDUCTION and LED</b>	Electronic Ballast High Power Factor 120V-60Hz AC	<b>ELECTRICAL/HID</b>	Magnetic Ballast HPF/120-208-240-277V/50Hz

**Special options**

Please Note: Standard Features May Change if Fixtures are Ordered with Special Option(s).

<b>BALLAST</b>	<input type="checkbox"/> V 277 Volt	<b>ACCESSORIES</b>	<input type="checkbox"/> BF Baffle	<input type="checkbox"/> PG Polycarbonate Guard
<b>FINISH</b>	<input type="checkbox"/> FCU Custom	<input type="checkbox"/> EPC External Photocell	<input type="checkbox"/> GLS Glare Shield	<input type="checkbox"/> RGLS Reverse Glare Shield
<b>KELVIN</b>	<input type="checkbox"/> 3500K <input type="checkbox"/> 4100K	<input type="checkbox"/> IPC Internal Photocell	<input type="checkbox"/> LY Large Yoke	<input type="checkbox"/> SBR Swivel Bracket
	<input type="checkbox"/> MIA Made In America	<input type="checkbox"/> MAR6 6" Mounting Arm, Gasket & Hardware	<input type="checkbox"/> PAR Heavy Duty Adjustable Pole Arm with Angle Indicator	<input type="checkbox"/> SC 3" Steel Cable with Clear Vinyl Coating, Steel Eye and Loop Ends
		<input type="checkbox"/> SF Adjustable Slip Fitter with Angle Indicator		<input type="checkbox"/> WG Wire Guard

For Additional Accessories and Options Visit [www.aslighting.com](http://www.aslighting.com)

ASL  
25 Twelfth Street  
Brooklyn, NY 11215-3820

Toll Free  
Phone: 800-369-1101  
Fax: 800-552-3465

Local  
Phone: 718-369-1100  
Fax: 718-369-1105

Online  
email: [info@aslighting.com](mailto:info@aslighting.com)  
visit: [www.aslighting.com](http://www.aslighting.com)



© copyright 2008 by American Scientific Lighting Corp. All rights reserved.

**OFT**