



Fixture specification

MODEL #: **OFE**

STYLE / LAMP / LAMP / WATTAGE / KELVIN / BALLAST / FINISH / LENS / ACCESSORIES / SIZE / COMPLIANCE
QTY TYPE DETAIL

PROJECT : _____ TYPE : _____ NOTE : _____

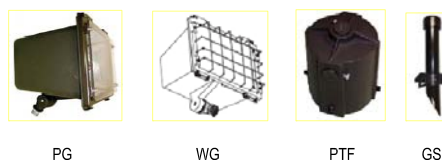
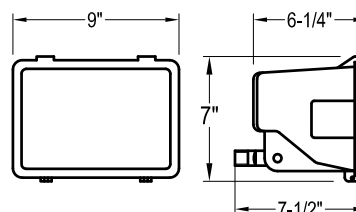

FIXTURE FEATURES

- EACH FIXTURE THERMALLY TESTED TO INSURE LONGEVITY
- MAXIMUM LIGHT DISTRIBUTION THROUGHOUT LENS
- OVER CURRENT, OVER VOLTAGE, SHORT CIRCUIT PROTECTION

BASE: DIE CAST ALUMINUM

MOUNTS VERTICAL OR HORIZONTAL WITH 1/2" PIPE THREAD

FINISH: BRONZETONE

LENS: HIGH IMPACT TEMPERED GLASS
HINGED LENS FRAME SECURELY SNAPS
LOCKS TO HOUSING WITHOUT SCREWS

POWER FACTOR: HIGH

INPUT VOLTAGE: 120V/50/60Hz
COMPLIANCE: UL AND/OR CSA LISTED
KELVIN: 3000
CRI: 80

MADE IN AMERICA
WET LOCATION

LED LIGHT SOURCE

- LG / NICHIA BRAND LED CHIPS
- CONSTANT CURRENT DESIGN AVERAGE 100 - 120LPM (LUMEN PER WATT) AT MODULE EFFICACY

- TRIAC OR ELECTRONIC LOW VOLTAGE DIMMING DOWN TO 5% WITH WALL BOX DIMMERS
- DRIVER: UL LISTED
- MODULE: CSA LISTED

- LM80 & LM82 TESTED
- ROHS COMPLIANT
- LIFE HOURS: 50,000
- WARRAANTY: LIMITED 5 YEARS

SYSTEM WATTAGE	LED ENGINE LUMENS					LEGACY 30K SUBSTITUTE
	2700K	3000K	3500K	4000K	5000K	
10 / 12 DRIVERLESS		1000 / 800		1000 / 800		CFL 13
15 DRIVERLESS		1200 / 1500		1200 / 1500		CFL 2 x 13
22 / 25 DRIVERLESS		1800 / 2500		1800 / 2500		CFL 3 x 13

SPECIAL OPTIONS

- DRIVER
- DV 120 / 277 (NON DIMMABLE)
 - DVD 120 / 277 (0-10V DIMMABLE)
 - EMG EMERGENCY
 - EMGR EMERGENCY REMOTE

- FINISH
- FW WHITE
- COMPLIANCE
- ES ENERGY STAR (WHEN SPECIFIED)

- KELVIN
- 2700K
 - 3500K
 - 4000K
 - 5000K

- ACCESSORIES
- EPC EXTERNAL PHOTOCELL
 - FUS FUSE
 - GS GROUND STAKE
 - IB INDIVIDUAL BOX
 - IPC INTERNAL PHOTOCELL
 - OC OCCUPANCY SENSOR
 - PG POLYCARBONATE GUARD
 - PTF POST TOP FITTER
 - SP SURGE PROTECTOR
 - WG WIRE GUARD

For Additional Accessories and Options Visit www.aslighting.com

ASL
25 Twelfth Street
Brooklyn, NY 11215-3820

Toll Free
Phone: 800-369-1101
Fax: 800-552-3465



Local
Phone: 718-369-1100
Fax: 718-369-1105

Online
email: info@aslighting.com
visit: www.aslighting.com

© copyright 2008 by American Scientific Lighting Corp. All rights reserved.

OFE