



# Fixture Specification

MODEL #: **ING**

STYLE / LAMP / LAMP / WATTAGE / KELVIN / BALLAST / FINISH / LENS / ACCESSORIES / SIZE / COMPLIANCE  
QTY TYPE DETAIL

PROJECT : \_\_\_\_\_ TYPE : \_\_\_\_\_ NOTE : \_\_\_\_\_

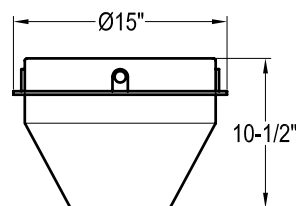
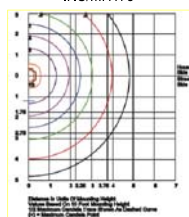
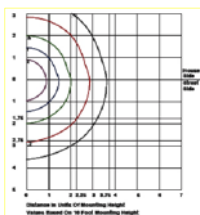

### Light Source

Type	Triple	High Pressure Sodium				Metal Halide				
Wattage	42	50	70	100	150	50	70	100	150	175
Quantity	2	1	1	1	1	1	1	1	1	1

### Standard Features

<b>HOUSING</b>	Die Cast Aluminum 1/2" Threaded Apertures for Conduit and/or Photocell Mounts over Electrical Box or to Structure for Surface Conduit	<b>FINISH</b>	Architectural Bronzestone	<b>LENS</b>	Extended Clear Prismatic Polycarbonate UV Stabilized Non Yellowing
<b>ELECTRICAL/FLUORESCENT</b>	Electronic Ballast High Power Factor 120/277V-60Hz AC UL Listed Wet Location	<b>ELECTRICAL/HID</b>	Magnetic Ballast HPS 50/NPF/120-277V MH 50/HPF/120-277V All Other Wattages: HPF/120-208-240-277V	<b>SOCKET/HID</b>	Porcelain 4KV Pulse Rated Medium Base
		<b>LAMP</b>	Quad and Triple - 2700K		

### Special options

Please Note: Standard Features May Change if Fixtures are Ordered with Special Option(s).

<b>BALLAST</b>	<input type="checkbox"/> DV 120/277 <input type="checkbox"/> HPF High Power Factor <input type="checkbox"/> V 277 Volt	<b>FINISH</b>	<input type="checkbox"/> FCU Custom	<b>ACCESSORIES</b>	<input type="checkbox"/> EPC External Photocell
<b>KELVIN</b>	<input type="checkbox"/> 3500K <input type="checkbox"/> 4100K	<b>TECHNOLOGY</b>	<input type="checkbox"/> GU24 ( Energy Star Compliant Component ) <input type="checkbox"/> LED <input type="checkbox"/> Occupancy Sensor	<b>COMPLIANCE</b>	<input type="checkbox"/> ES Energy Star <input type="checkbox"/> MIA Made In America

For Additional Accessories and Options Visit [www.aslighting.com](http://www.aslighting.com)

ASL  
25 Twelfth Street  
Brooklyn, NY 11215-3820

Toll Free  
Phone: 800-369-1101  
Fax: 800-552-3465

Local  
Phone: 718-369-1100  
Fax: 718-369-1105

Online  
email: [info@aslighting.com](mailto:info@aslighting.com)  
visit: [www.aslighting.com](http://www.aslighting.com)



© copyright 2008 by American Scientific Lighting Corp. All rights reserved.

