



LED FIXTURE SPECIFICATION

MODEL # **MAB**



FINAL MODEL #			
PROJECT			
TYPE		AREA	
NOTES			

STANDARD FEATURES: CEILING INDOOR

Fixture thermally tested to ensure longevity
 Maximum light distribution throughout lens
 Over current/voltage short circuit protection
 UL and/or CSA Compliant Listed
 Constant Current Design

FIXTURE	LED ENGINE
BASE Aluminum FINISH Clear Glass LENS Interior White LOCATION Damp COMPLIANT RoHS LIFE HOURS 50,000 WARRANTY Limited 5 Years	LG/NICHIA/SAMSUNG, LED CHIPS LUMENS PER WATT AVG 100-120 @Module Efficacy KELVIN 27K 30K 35K 40K 50K CRI 80+ DRIVER 120 VOLTS 50/60Hz POWER FACTOR High TRIAC OR ELECTRONIC Low Voltage Dimming Down To 5% With Wall Box Dimmers TESTED LM80 and LM82

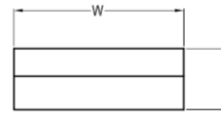

LED LIGHT SOURCE OPTIONS* ORDERING INFORMATION:

EXAMPLE

WATTAGE: 12	KELVIN: 3000k	SIZE: 5x2
WATTAGE:	KELVIN:	SIZE:

SIZE OPTIONS	
S7	H3 ^{1/4}
S9 ^{1/4}	H3 ^{1/4}

SYSTEM WATTAGE	2700K WARM WHITE	3000K SOFT WHITE	3500K NEUTRAL	4000K COOL WHITE	5000K DAYLIGHT	LEGACY EQUIVALENT
15		1120				CFL 13
20		1500				CFL 2 X 13

SPECIAL OPTIONS (please specify if applicable)

EXAMPLE

DRIVER: DVD	FINISH: FCU	LENS: LCU	ACCESSORIES: FUS	TECHNOLOGY: CT
DRIVER:	FINISH:	LENS:	ACCESSORIES:	TECHNOLOGY:

DRIVER	FINISH	LENS	ACCESSORIES	TECHNOLOGY
<input type="checkbox"/> DV 120/277 (Non Dimmable) <input type="checkbox"/> DVD 120/277 (0-10v Dimmable)	<input type="checkbox"/> FB Black <input type="checkbox"/> FBR Bronzestone <input type="checkbox"/> FCU Custom Any RAL Finish <input type="checkbox"/> FSN Satin Nickel <input type="checkbox"/> FW White	<input type="checkbox"/> LCU Custom	<input type="checkbox"/> CCS Cable, Cord Suspension System <input type="checkbox"/> CPS Cable, Pendant Suspension System <input type="checkbox"/> FI Finial <input type="checkbox"/> FUS Fused <input type="checkbox"/> IB Individually Boxed <input type="checkbox"/> PCH Pull Chain <input type="checkbox"/> PK1 Canopy/Pendant Kit/1 ROD <input type="checkbox"/> PK2 Canopy/Pendant Kit/2 RODS <input type="checkbox"/> PK3 Canopy/Pendant Kit/3 RODS <input type="checkbox"/> SRP Surge Protection	<input type="checkbox"/> BLD Bi-Level Dimming <input type="checkbox"/> CT LED Color Tuning <input type="checkbox"/> EMG Emergency (Any Lumens Package) <input type="checkbox"/> EMGR Emergency Remote <input type="checkbox"/> OS Occupancy Sensor On/Off <input type="checkbox"/> OSCD Occupancy Sensor Step Dimming

ASL LIGHTING

25 TWELFTH ST. BROOKLYN, NY 11215-3820 | EMAIL: INFO@ASLLIGHTING.COM | WWW.ASLLIGHTING.COM

TOLL FREE: P 800-369-1101 F 800-552-3465 | LOCAL: P 718-369-1100 F 718-369-1105

Specifications and dimensions are subject to change without notice / Consult your ASL lighting representative.

© Copyright 2016 By American Scientific Lighting Corporation. All rights reserved.

