



Fixture Specification



MODEL #: **BSB**

STYLE / LAMP / LAMP / WATTAGE / KELVIN / BALLAST / FINISH / LENS / ACCESSORIES / SIZE / COMPLIANCE
QTY TYPE DETAIL

PROJECT : _____ TYPE : _____ NOTE : _____

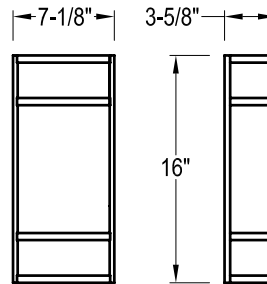

Light Source

Type	Twin Tube		Quad	
Wattage	18	24	18	26
Quantity	1/2	1/2	2	2

Standard Features

BASE	Aluminum Construction Mounts to Electric Box with Center Nipple	FINISH	Polished Brass	LENS	Frosted White Acrylic UV Stabilized Non Yellowing
LAMP	Twin and Quad - 2700K	TECHNOLOGY	Electronic Ballast Normal Power Factor 120V-60Hz AC UL Listed Damp Location	NOTE	Open Ends

Special options

Please Note: Standard Features May Change if Fixtures are Ordered with Special Option(s).

BALLAST	<input type="checkbox"/> DV 120/277 <input type="checkbox"/> EBD Dimmable <input type="checkbox"/> EMG Emergency <input type="checkbox"/> HPF High Power Factor <input type="checkbox"/> V 277 Volt	FINISH	<input type="checkbox"/> FB Black <input type="checkbox"/> FBZ Bronzetone <input type="checkbox"/> FCU Custom <input type="checkbox"/> FPA Polished Aluminum <input type="checkbox"/> FSB Satin Brass <input type="checkbox"/> FSC Satin Chrome <input type="checkbox"/> FW White	LENS	<input type="checkbox"/> FA Faux Alabaster <input type="checkbox"/> SWA Smooth White Acrylic <input type="checkbox"/> WAPCI White Acrylic Perforated Chrome Image
KELVIN	<input type="checkbox"/> 3500K <input type="checkbox"/> 4100K	TECHNOLOGY	<input type="checkbox"/> GU24 (Energy Star Compliant Component) <input type="checkbox"/> LED <input type="checkbox"/> Occupancy Sensor	COMPLIANCE	<input type="checkbox"/> ES Energy Star <input type="checkbox"/> MIA Made In America

For Additional Accessories and Options Visit www.aslighting.com

ASL
25 Twelfth Street
Brooklyn, NY 11215-3820

Toll Free
Phone: 800-369-1101
Fax: 800-552-3465

Local
Phone: 718-369-1100
Fax: 718-369-1105

Online
email: info@aslighting.com
visit: www.aslighting.com



© copyright 2008 by American Scientific Lighting Corp. All rights reserved.

BSB